

CGWS-275 Wood/SS Corner Guard

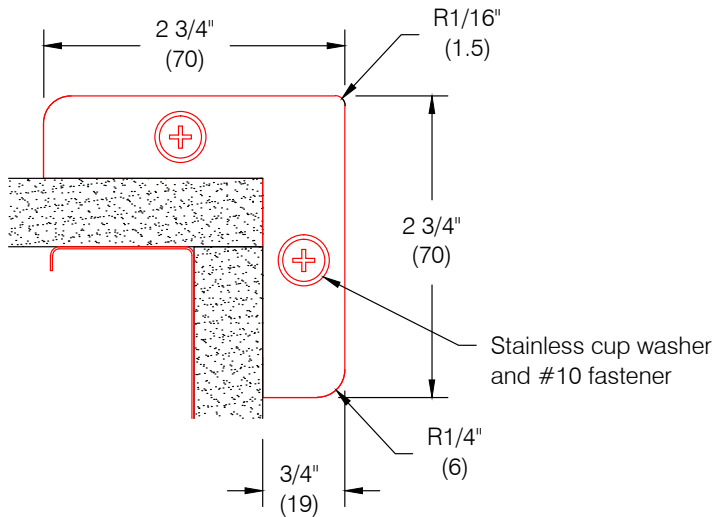

Features:

- Stock lengths: 4'-0" (1219), 8'-0" (2438),
- Custom cut lengths available
- Stainless Steel top and bottom caps

Finishes:

Wood

- Manufacturer's standard stain colors
- Oak, maple, or ash hardwoods
- Custom woods are available
- Custom stain colors available

Stainless Steel

- Type 304
- #4 Polished Finish

All hardwoods have their own "personality" or special characteristics. Variations in color, grain pattern, and texture are to be expected, they are natural aspects of these materials.

(*) Specify wood type

A - Ash
 M - Maple
 O - Oak

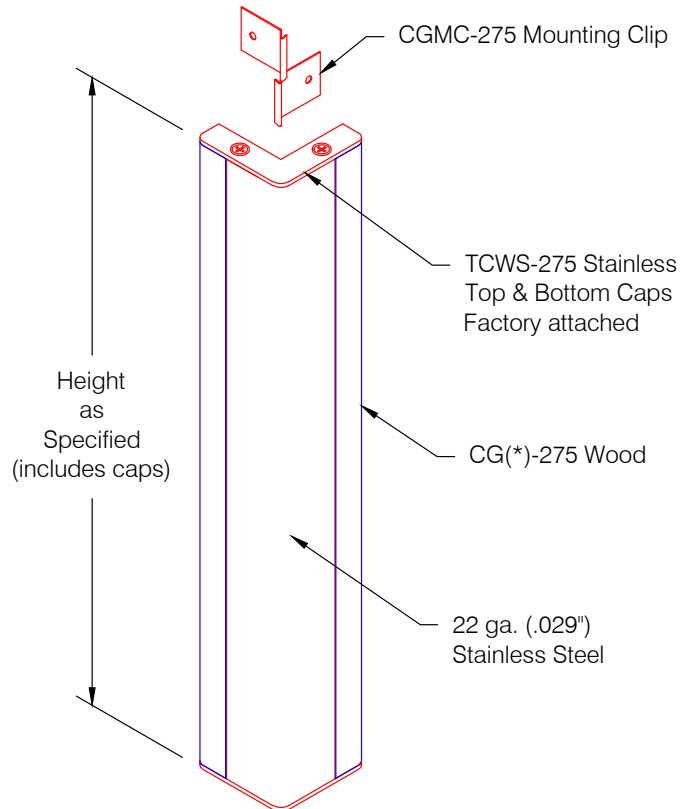
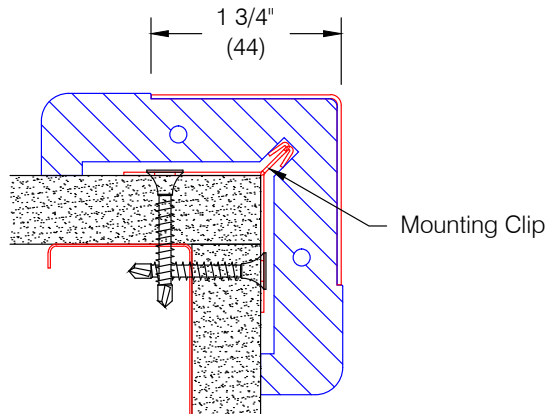

Pawling Corporation reserves the right to discontinue a design or modify an existing design without prior notice

Customer :	Project :	WD.174.2b
Architect :	Sales Rep :	

CGWS-2751 Wood/SS Corner Guard 135°

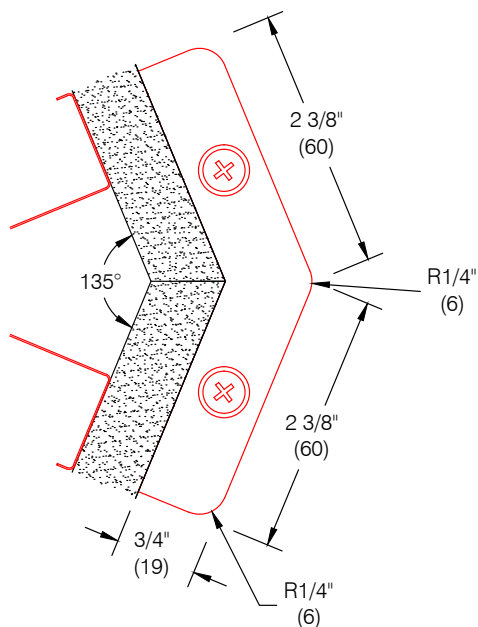

Features:

- Stock lengths: 4'-0" (1219), 8'-0" (2438),
- Custom cut lengths available
- Stainless Steel top and bottom caps

Finishes:

Wood

- Manufacturer's standard stain colors
- Oak, maple, or ash hardwoods
- Custom woods are available
- Custom stain colors available

Stainless Steel

- Type 304
- #4 Polished Finish

All hardwoods have their own "personality" or special characteristics. Variations in color, grain pattern, and texture are to be expected, they are natural aspects of these materials.

(*) Specify wood type

A - Ash

M - Maple

O - Oak

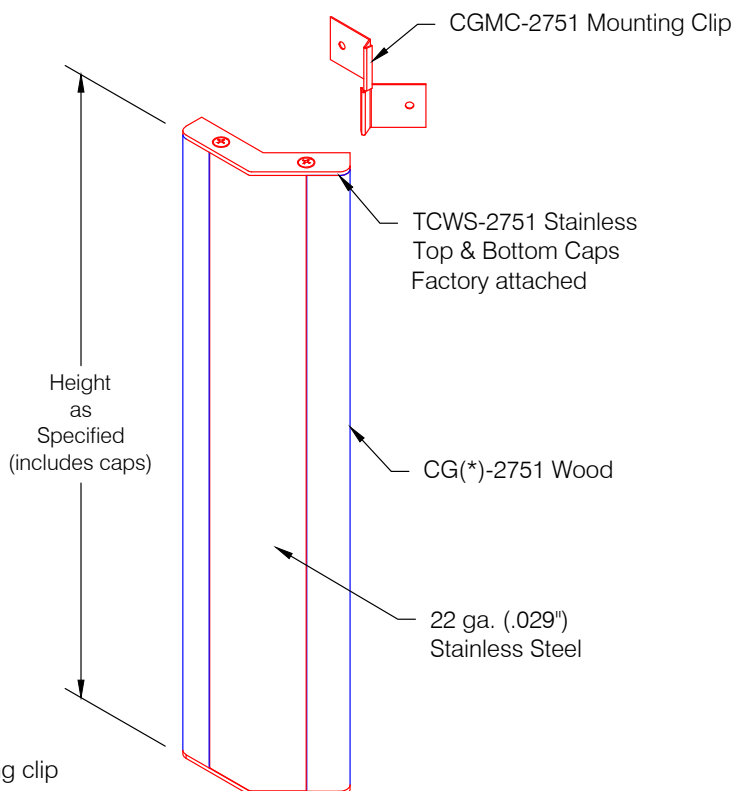
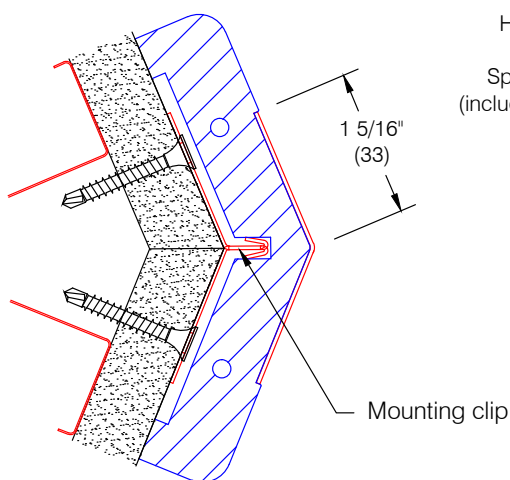

Pawling Corporation reserves the right to discontinue a design or modify an existing design without prior notice

Customer :	Project :	WD.174.1b
Architect :	Sales Rep :	



Pro • Tek[®] Wall Protection Systems

Architectural Building Products Since 1945

CGWS-275B Wood/SS Corner Guard



Features:

- Stock lengths: 4'-0" (1219), 8'-0" (2438),
- Custom cut lengths available
- Standard with Stainless Steel top and bottom closure caps

Finishes:

Wood

- Manufacturer's standard stain colors
- Oak, maple, or ash hardwoods
- Custom woods are available
- Custom stain colors available

Stainless Steel

- Type 304
- #4 Polished Finish

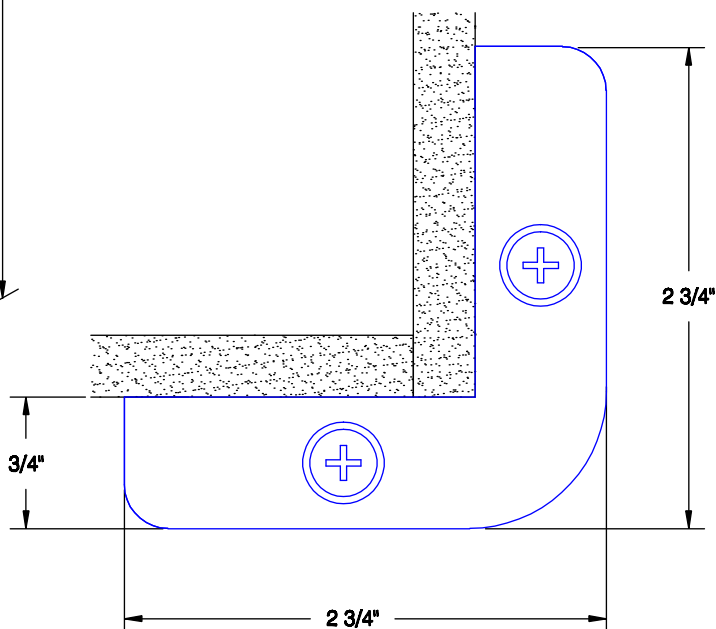

Pawling Corporation reserves the right to discontinue a design or modify an existing design without prior notice

Customer :	Project :	WD.174.0a
Architect :	Sales Rep :	