

CG-51-Endwall Stainless End Guard

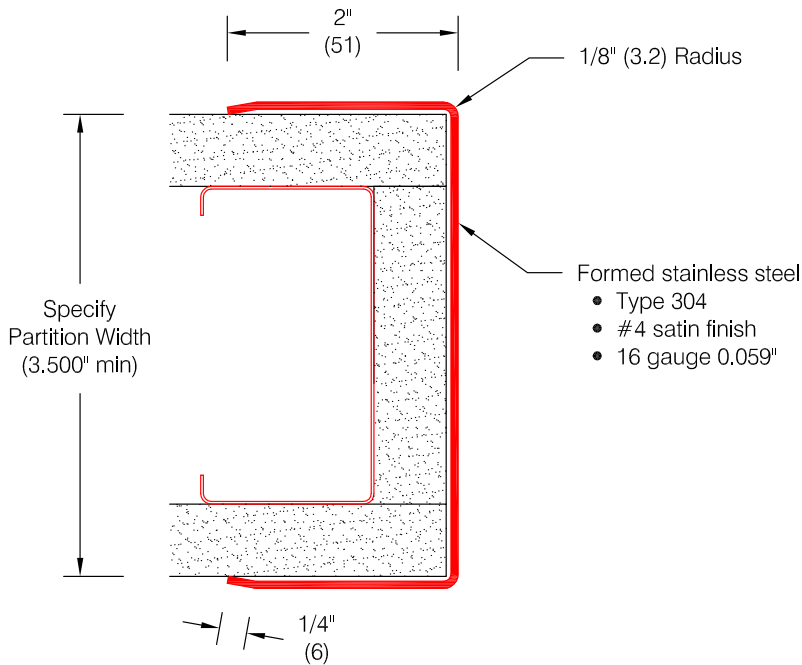

Features:

- Custom lengths, angles, and wing sizes are available
- Minimum partition width: 3 1/2" (89)
- Type 304 stainless steel

Mounting Options:

- Standard mounting
Adhesive:
ADH-50 adhesive included
- Optional mounting
Drilled:
Clearance holes for #8 fastener
ABSS-113 #8 x 1 1/2" (38) oval head
sheet metal screw and ABCW-132
stainless cup washer supplied
separately as required

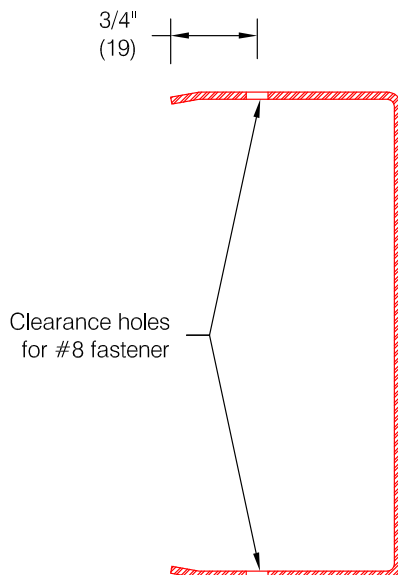

Optional Drilling:

- Standard spacing: 3" from each end and spaced evenly not to exceed 36" oc

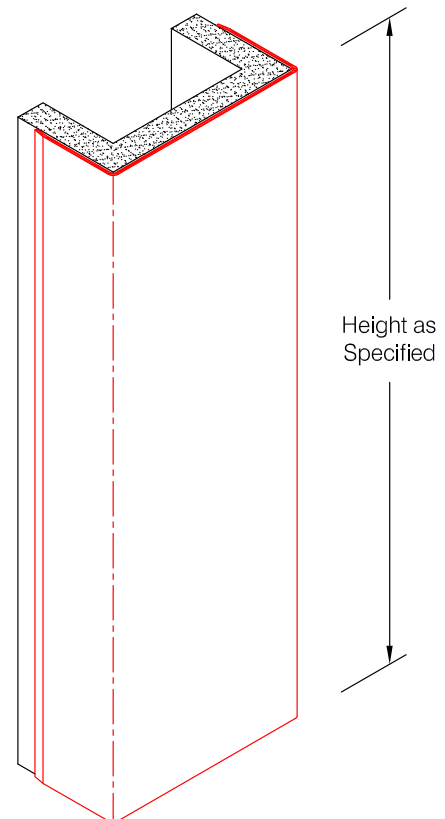

Pawling Corporation reserves the right to discontinue a design or modify an existing design without prior notice

Customer :	Project :	WD.122.1b
Architect :	Sales Rep :	

CG-51 Stainless Corner Guard

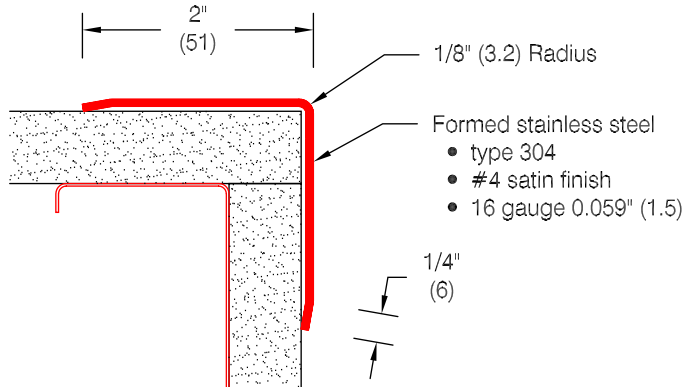

Features:

- Custom lengths, angles, and wing sizes are available
- Type 304 stainless
- Stock lengths: 4'-0" (1219) & 8'-0" (2438)

Mounting Options:

- Standard mounting
Adhesive:
ADH-50 adhesive supplied separately
- Optional mounting
Drilled:
Clearance holes for #8 fastener
ABSS-113 #8 x 1 1/2" (38) oval head sheet metal screw and ABCW-132 stainless cup washer supplied separately as required

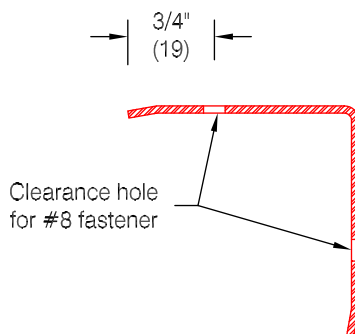

Optional Drilling:

- Standard spacing: 3" (76) from each end and spaced evenly not to exceed 36" (914) oc

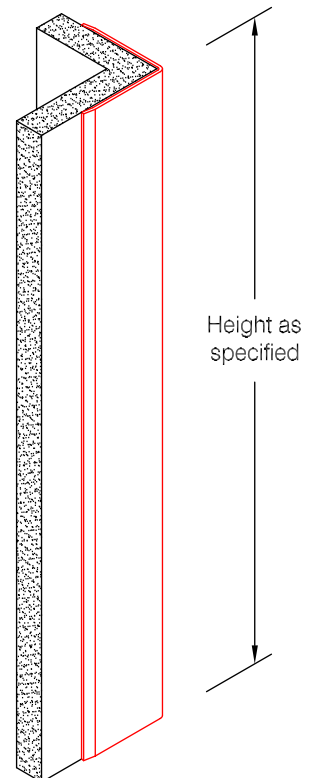

Pawling Corporation reserves the right to discontinue a design or modify an existing design without prior notice

Customer :	Project :	WD.122.0a
Architect :	Sales Rep :	